

Super Combo

VENTING

ALL-IN-ONE COMBO WASHER ⊕ DRYER

Model: 4800 V

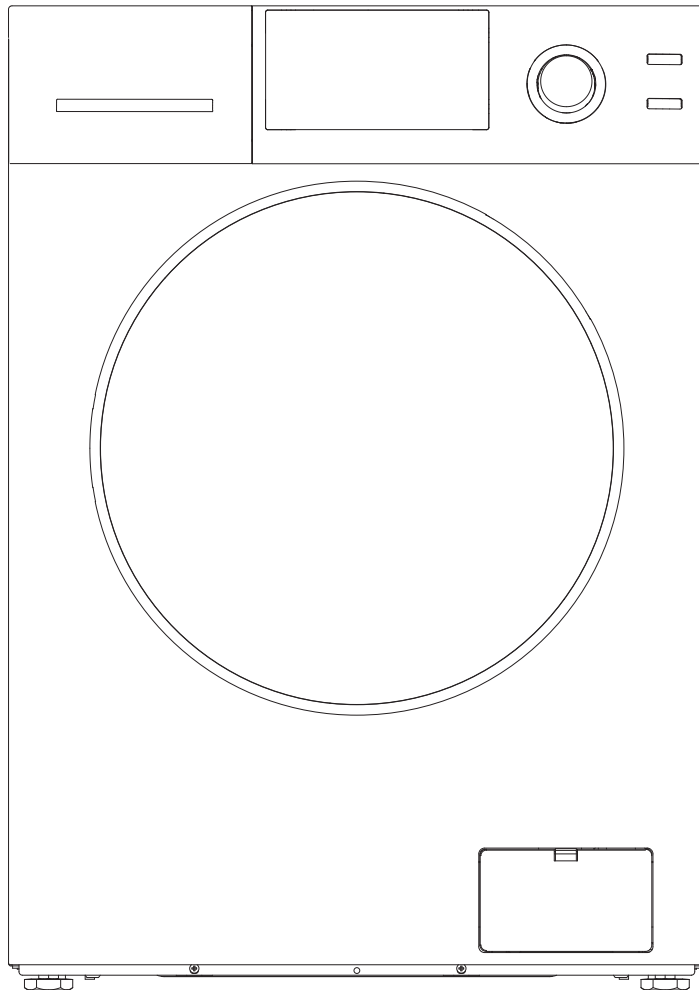

OWNER'S MANUAL

Read the instructions carefully and keep for future reference. Information maybe updated from time to time so please refer to the website for the latest version of the manual.



DO NOT RETURN TO STORE!

HAVE QUESTIONS OR NEED SERVICE?



1-800-776-3538



Service@ApplianceDesk.com

TABLE OF CONTENTS

**Please read the Owner's Manual carefully before using your
ALL-IN-ONE COMBO WASHER ⊕ DRYER**

Introduction.....	1
Warranty Information.....	2
Technical Specifications	5
Safety.....	6
Diagram of the Combo Washer ⊕ Dryer.....	8
Unpacking and Leveling	9
Handling and Placement.....	10
Electrical and Plumbing.....	11
Connecting Hoses	12
Operating Instructions	14
Program Selection Chart	15
Control Panel.....	16
Display Panel.....	17
Special Features and Programs.....	18
Maintenance.....	19
Troubleshooting	20
Error Codes.....	21

INTRODUCTION

Congratulations on your new Washer⊕Dryer! In addition to its contemporary design, this is a highly sophisticated engineered product that will give you many years of satisfaction.

Here are some of the best reasons for buying your Washer⊕Dryer

1. Space Saving

By combining the two functions of washer and dryer in one unit, the space taken for the second unit, i.e. separate dryer, is saved.

2. Placement Options

The Washer⊕Dryer's sleek and compact size design makes it a perfect appliance for any kitchen or laundry room.

3. Water & Energy Saving

New automatic water level feature determines the amount of water required based on quantity of clothes which helps save water. Also this appliance is engineered to provide valuable energy savings e.g., LED display goes off after 5 mins to save energy.

4. Better Clothing Appearance

This Washer⊕Dryer has no agitator to damage your clothes so they look better and last longer.

5. Specialized Wash Programs

There are special wash programs for Sanitize, Allergen, Winterize etc.

6. Refresh Function

The refresh function keeps your clothes warm and fluffy always.

7. High spin speed

With a high spin speed of 1400 rpm, more water is extracted, allowing improved dry times.

8. Easy Operation

This appliance is simple to use as a washer or as a dryer – or it can go seamlessly from wash to the dry functions.

9. Sensor Dry

This function automatically selects the ideal dry level to make sure your clothes are dried with utmost perfection based on wash cycle used.

10. Lint Free Maintenance

Since the machine has a self-cleaning pump, this appliance needs no cleaning of lint after drying. Instead, there is a convenient coin trap.

11. Portability

The appliance can be made portable with the attachment of the portability kit (Accessory Part #1070 sold separately) where needed.

WARRANTY INFORMATION

Your appliance is protected by this warranty under normal, personal, family or household use for 1 Year Parts & Labor and limited commercial use (90 days) in USA and Canada

WARRANTY

Consolidated Brands undertakes to the consumer / owner to repair or, at our option, to replace any part of this product which proves to be defective in workmanship or material under normal personal, family or household use, in USA and Canada, for a period of one year parts & labor from the date of original purchase. For commercial use, the product is warranted for a period of 90 days.

During this period, we will provide all labor and parts necessary to correct such defect, free of charge, if the appliance has been installed and operated in accordance with the written instructions provided with the appliance. Ready access to the appliance, for service, is the responsibility of the consumer / owner. If a unit is installed in a closet or cabinet, it should be removed by the consumer / owner, for access by service technicians. If this is not done, there will be an extra charge.

EXCLUSIONS

In no event shall Consolidated Brands be liable for incidental or consequential damages or for damages resulting from external causes such as abuse, operation misuse, neglect, alterations, normal wear and tear, incorrect voltage or acts of God. This warranty does not cover service calls which do not involve defective workmanship, damage due to other products while combined use with this product or materials covered by this warranty. Accordingly, diagnosis and repair costs for a service call which does not involve defective workmanship or materials will be the responsibility of the consumer / owner.

Most work is covered. The defining factor is, has the machine malfunctioned (Consolidated Brands is responsible) or has the customer omitted or done something to cause malfunction (customer is responsible). Some states do not allow the exclusion or limitation of incidental or consequential damages, so the above limitation or exclusion may not apply to you.

You can register your Warranty by either of the following methods:

1. Scan QR Code

- Open Smart Phone
- Open Camera
- Click the Link



2. Register online at ApplianceDesk.com/Warranty

Note: QR Code is also used to obtain Product Information, Manuals and Updates

WARRANTY SERVICE

This warranty is given by:

Consolidated Brands
10222 Georgibelle Drive, Suite 200,
Houston, TX 77043-5249

Customer Service: **Appliance Desk**
Phone / Text: 1-800-776-3538
Email: Service@ApplianceDesk.com
Web: www.ApplianceDesk.com
Business hours: 9:00 am to 5:00 pm weekdays

THE FOLLOWING IS NOT COVERED UNDER WARRANTY

A) Installation

1. Non-removal of shipping rods, causing vibration / internal damage.
2. Non-adjustment of feet to level machine, causing vibration / internal damage.
3. Not conforming to minimum space requirements, causing excess heat and resulting in damage to internal components.
4. Using incorrect length of venting i.e. more than 10 feet unless used with a booster exhaust fan.
5. Placement in a corrosive environment.
6. Incorrect water pressure i.e., below 7.25 psi or above 145 psi.
7. Incorrect water inlet hose installation (use only factory supplied hoses with metric threads on the L-shaped side to fit water valve).

B) Maintenance

1. Non-cleaning of coin trap for debris, causing the unit to not drain out water and resulting in drain pump malfunction.
2. Non-cleaning of exhaust fan and exhaust hose for lint, causing the unit to not dry properly.
3. Improper maintenance (such as, but not limited to, scale build-up, freeze damage, or vent blockage).

C) Damage

1. Breakage of cosmetic parts e.g., door handle, knob.

D) Other

1. Accident, abuse, or misuse.
2. Using solvents to clean the machine or wash clothes, causing damage.
3. Misapplication of this product e.g., use in a non-household / commercial environment.
4. Any other cause not due to defects in materials or workmanship.
5. Problems or damage due to fires, flooding, electrical surges, freezing or any acts of God.
6. Any damage caused by poor water quality.
7. Operating the appliance with anything other than potable water at all times.
8. Force majeure.

California Proposition 65

WARNING: This product contains chemicals known to the State of California to cause cancer and birth defects or other reproductive harm.

Warranty Limitations

1. If a unit is located more than 25 miles away, there will be a trip charge.
2. If a unit is in a remote area more than 75 miles away, the machine should be taken to the technician's workshop.
3. If the unit is installed in a 5th wheel RV, in a location behind the axle, it will not be covered under warranty.
4. All repairs or replacements are warranted only for the remainder of the original warranty period.
5. If a return or replacement is required, allow 3-4 weeks to process.
6. Replacement units will be delivered with curbside delivery only.
7. We may require the return of products or parts to our warranty department for which the shipping charges are to be pre-paid by the consumer / owner.
8. Charges may be incurred if warranty coverage is not applicable.
9. Service would be provided from Monday to Friday between normal business hours.

GENERAL

Since it is the responsibility of the consumer / owner to establish the warranty period by verifying the original purchase date, Consolidated Brands recommends that a receipt, delivery slip or some other appropriate payment record be kept for that purpose. This warranty gives you specific legal rights, and you may also have other rights which vary from state to state.

All rights reserved. Manual subject to change without notice.

TECHNICAL SPECIFICATIONS

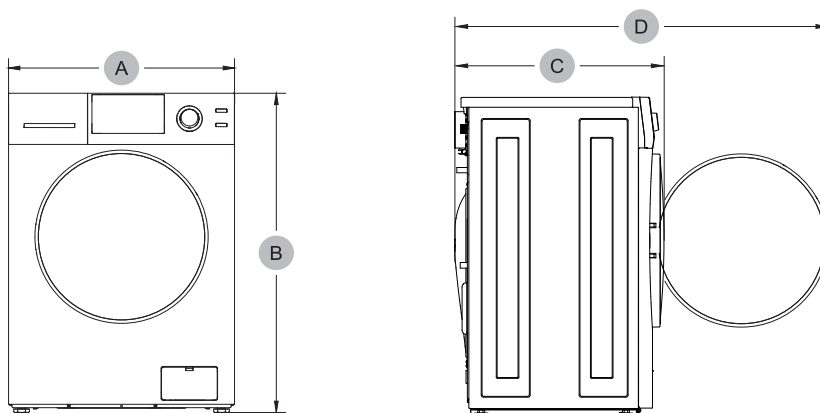

Type		Front loading washer-dryer combo
Model		4800 V
Dimensions (inches / mm)	A. Width	23.6 / 600
	B. Height-overall	33.5 / 850
	C. Depth	21.85 / 555
	D. Depth with door open	38.54 / 979
Rated voltage		110-120V/60Hz 12A
Water pressure (psi / Mpa)		7.25 - 145 / 0.05- 1.00
Wash capacity (lb / kg)		15 / 6.8
Dry capacity (lb / kg)		Max. 9 / 4.0
Net weight (lb / kg)		160 / 73
Spin revolution		Max. 1,400 rpm
Power consumption (W)	Washing	120 W
	Spin	500 W
	Wash heater	1,000 W
	Dry heater	1,300 W



Intertek

4007606

US N° 4007606 CANADA

The ETL Listed Mark is the legal equivalent to the UL and CSA Listed Marks

Note: All rights reserved.
Designs, Specifications and Manual subject to change without notice.

IMPORTANT SAFETY INSTRUCTIONS

Your Combo Washer ⊕ Dryer has been manufactured in compliance with safety regulations to protect you and your family.

WARNING – To reduce the risk of fire, electric shock, or injury to persons when using your appliance, follow basic precautions, including the following:

1. Read all instructions before using the appliance.
2. Do not wash or dry articles that have been previously cleaned in, washed in, or spotted with gasoline, dry-cleaning solvents, other flammable or explosive substances, as they emit vapors that could ignite or explode.
3. Do not allow children to play on or in the appliance. Close supervision of children is necessary when the appliance is used near children.
4. Before the appliance is removed from service or discarded, remove the door.
5. Do not reach into the appliance if the tub or drum is moving.
6. Do not install or store this appliance where it will be exposed to the weather.
7. Do not tamper with controls.
8. Do not repair or replace any part of the appliance or attempt any servicing unless specifically recommended in the user-maintenance instructions or in published user-repair instructions that you understand and have skills to carry out.
9. Do not add gasoline, dry-cleaning solvents, or other flammable or explosive substances to the wash water. These substances give off vapors that could ignite or explode.
10. Under certain conditions, hydrogen gas may be produced in a hot water system that has not been used for 2 weeks or more. **HYDROGEN GAS IS EXPLOSIVE.** If the hot water system has not been used for such a period, before using a washing machine or combination washer-dryer, turn on all hot water faucets and let the water flow from each for several minutes. This will release any accumulated Hydrogen.
11. Do not use fabric softeners or products to reduce static unless recommended by the manufacturers of the fabric softener product.
12. Do not use heat to dry articles containing foam rubber or similarly textured rubber-like materials.
13. Check the Coin Trap every few months to remove any coins, buttons or similar size objects.
14. For vented washer-dryers keep the exhaust opening and surrounding areas free from accumulation of lint, dust, and dirt.
15. Do not place items exposed to cooking oils in your dryer. Item contaminated with cooking oils may contribute to a chemical reaction that could cause a load to catch fire.
16. To reduce the risk of fire due to contaminated loads, the final part of a tumble dryer cycle occurs without heat (cool down period). Avoid stopping a tumble dryer before the end of the drying cycle unless all items are quickly removed and spread out so that the heat is dissipated.

SAVE THESE INSTRUCTIONS

SAFETY

SAFE DISPOSAL

Disposing of the packing

The shipping package has protected your new appliance on its way to your home. All packaging materials are non-polluting and recyclable. Please dispose of packing material according to local environmental regulations.



Disposing of your old appliance

Old Appliances are not worthless trash! Valuable raw material can be recycled from old appliances. Please dispose of your old appliance according to local environmental regulations.

To prevent children from locking themselves in the appliance, remove the door.

⚠ DANGER ⚠

Keep children away from the shipping carton and packing components.
Danger of suffocation from plastic foil and folding cartons.

 CAUTION 	The model number and the serial number are on the label affixed to the back of the unit. These numbers are also available on the front of the cabinet behind the door.
RISK OF ELECTRIC SHOCK DO NOT OPEN	You should note the model and serial numbers of this unit in the space provided. Retain this booklet as a permanent record of your purchase to aid in identification in the event of theft.
CAUTION: TO REDUCE THE RISK OF ELECTRIC SHOCK, DO NOT REMOVE COVER (OR BACK). NO USER SERVICABLE PARTS INSIDE. REFER SERVICING TO QUALIFIED SERVICE PROFESSIONALS.	MODEL No: _____ SERIAL No: _____

HELPFUL HINTS

1. Your Washer⊕Dryer spins at a high 1400 rpm spin speed, which will extract more water especially from absorbent fabrics and reduce the degree of dampness as the machine goes into the drying mode. This will cut down on your drying time. Ensure the appliance is placed on a solid and level surface so that during the spinning, the machine will not move or shake.
2. **FABRIC SOFTENER:** After the wash cycle, the clothes can get stuck to the sides of the drum. USING LIQUID FABRIC SOFTENER WILL CAUSE THE CLOTHES TO UNSTICK IMMEDIATELY AND TUMBLE IN THE DRY CYCLE. THIS HELPS TO DRY CLOTHES FASTER AND CAUSES LESS WRINKLES.
3. **OVERLOADING:** The drum has a capacity of 19 lbs. The drum should be loaded only to 2/3 of its capacity otherwise it reduces air flow and causes increase in dry time.
4. **USE HIGH EFFICIENCY (HE) DETERGENT:** By using High Efficiency (HE) detergent, you are preventing suds from entering the condensing chamber. When suds enter the condensing chamber, the particles can clog up the chamber and the fan blower. Over time, this reduces drying efficiency and may require the fan blower (impeller) to be cleaned. For this and all other front-loading/horizontal-axis units, Front Loading detergents go a long way to improve the efficiency of the units.
5. **SORTING:** When sorting laundry always take into consideration the quantity and type of fabric in the load. Highly absorbent fabrics such as those used in towels or jeans will absorb more water and become very heavy when saturated. If you notice that your clothes are taking longer than usual to dry you may be overloading the machine, or washing too many highly absorbent articles in a single load.

DIAGRAM OF THE COMBO WASHER + DRYER

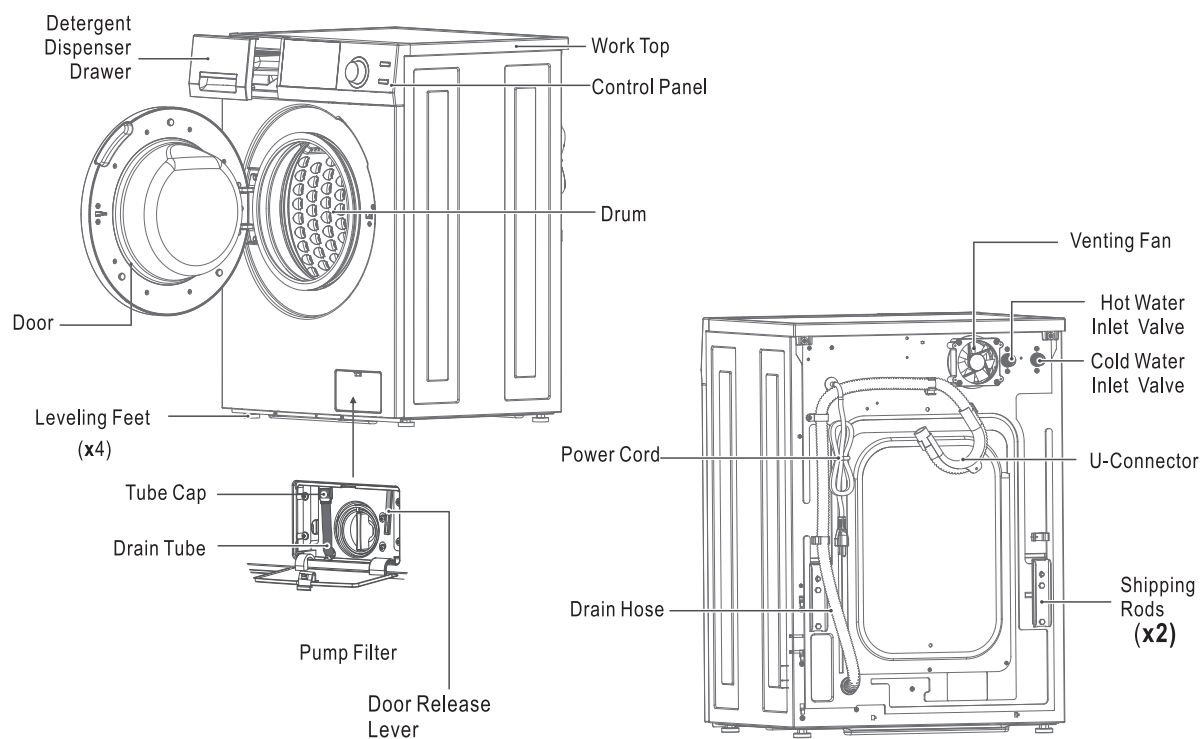

Factory supplied accessories

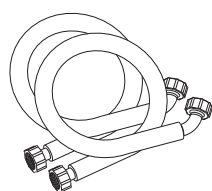

Inlet hose (2)



U-Connector for Drain hose

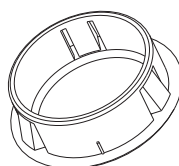

Blanking Caps (2)

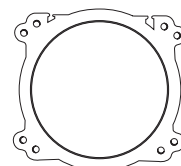

Vent Adapter

Inside the drum there is a packet of accessory parts supplied with your appliance. Check that all parts are there. If any are parts missing please contact customer service.

Any residual moisture inside the drum is due to the final testing which every appliance undergoes before leaving the factory.

UNPACKING and LEVELING

Remove the packing and check that the Washer ⊕ Dryer is undamaged. If you have any doubt, do not use the Washer ⊕ Dryer and call Customer Service. Keep all packing parts (plastic bag, foam rubber, screws, etc.) out of the reach of children since they could be dangerous.

Important: The inside of the Washer-Dryer consists of a free floating drum that is affixed with shipping rods at the back of the cabinet during transport (Fig.1). The power cord can be accessed by removing the shipping rods (Fig. 2 & 3). Close the holes left open by the rods with the caps provided (Fig. 4). The screws also need to be reinstalled (Fig. 4).

It is important for the machine to be perfectly level. For this reason, the machine is fitted with adjustable feet used for leveling the machine before use (Fig. 5).

⚠ CAUTION ⚠

The shipping rods must be removed before using the appliance for the first time and must be retained for any future transport. (e.g when moving).

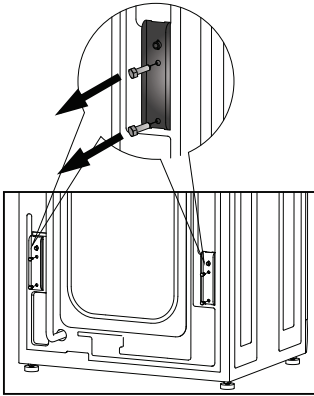

Fig. 1



Fig. 2

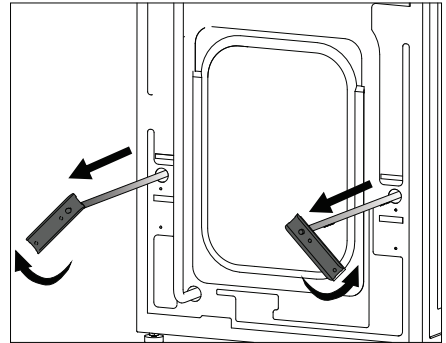

Fig. 3

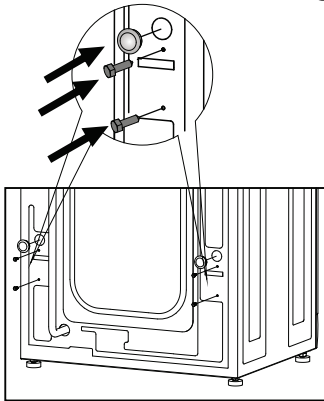

Fig. 4

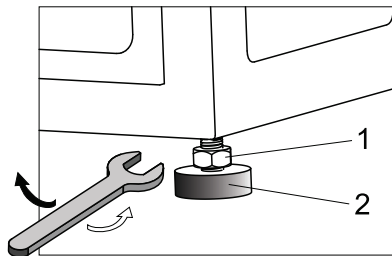

Fig. 5

! NOTE

- Save the rod assemblies for future use. To prevent damage to internal components, DO NOT transport the washer-dryer combo without reinstalling the shipping rods.
- Failure to remove shipping rods and retainers may cause severe vibration and noise, which can lead to permanent damage to the combo.
- The cord is secured to the back of the combo by a clamp with a shipping rod to help prevent operation with shipping rods in place.

HANDLING and PLACEMENT

Handling

- Please handle the machine carefully and use appropriate means while lifting and moving the machine so that it does not get damaged. Do not drag the machine on your floor. Do not hold on to protruding parts when lifting.
- If the appliance is located in a room which will be exposed to temperatures below freezing point, or if it is located in a cabin that is being shutdown for the winter, any residual water in the pump or water inlet hoses must be drained.

Washer ⊕ Dryer is Venting only
Ensure the appliance is placed in an area where it can be vented.

Placement

- Place the appliance on a hard and flat surface.
- Appliance stability is very important otherwise washer ⊕ dryer could “wander” during the spin cycles.
- Do not place the appliance outdoors or in an area exposed to freezing conditions.
Frozen hoses can tear / burst.
- Place the appliance in a protected, dry and well-ventillated area, with a power and water supply of sufficient capacity and a sufficient outlet in close proximity.
- Placement on carpet or wood increases vibrations.
 - Carpets – place on light carpet only.
 - Wood – brace floor with screws and place additional sheets of plywood before placement of unit.
- This unit's grounding should be done in accordance with local codes by a qualified technician.
- The unit should be plugged into a properly grounded three (3) prong electrical outlet of 110V/60Hz with minimum 15 Amps, It should not be controlled by a wall switch or pull cord which might be turned off accidentally.

The Washer ⊕ Dryer is designed to be Freestanding or Built-in. Ensure there is minimum clearance space around the appliance: 2 inches on either side and 3 inches at the front and at the back.

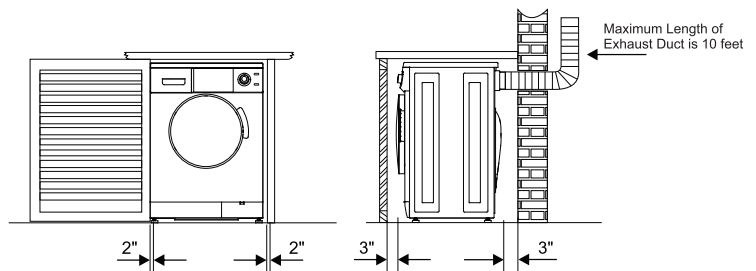

Fig. 6

Use 2.5" height platform to make the machine ADA compliant.

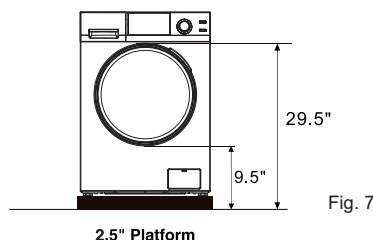

Fig. 7

Electrical Connection

Connect the plug to a power outlet - 110V / 60Hz with minimum 15 Amps. Make sure that the voltage and frequency available correspond with those stated on the serial number plate located on the machine. Do not use adaptors or extension cords since they could result in overheating and burn out.

This Washer⊕Dryer must be connected to an individual circuit identical to the one specified on the rating plate of the loading port protected by fuses or circuit breaker conforming to local codes.

GROUNDING

This appliance must be grounded. In the event of malfunction or breakdown, grounding will reduce the risk of electric shock by providing a path of least resistance for electric current. This appliance is equipped with a power cord having an equipment-grounding conductor and a grounding plug. The plug must be plugged into an appropriate outlet that is properly installed and grounded in accordance with all local codes and ordinances.

WARNINGS

- Improper connection of the equipment-grounding conductor can result in a risk of electric shock. Check with a qualified personnel or service representative if you are in doubt as to whether the appliance is properly grounded.
- Do not modify the plug provided with the appliance: if it will not fit the outlet, have a proper outlet installed by a qualified electrician.

Note: If the electrical power supply does not meet the specifications listed above, please call a licensed electrician.

Plumbing

Connecting to the Water Faucet

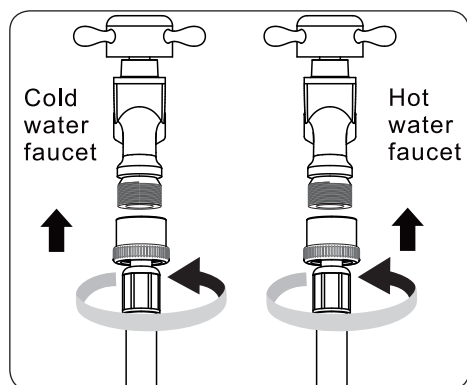

Fig.6

To connect the hoses to the water faucets:

- Connect the straight end of each hose to the cold or hot faucet.
- Turn the fittings by hand until they are tight, and then tighten them by just an additional two-thirds of a turn with a plier. Do not overtighten the fittings. They can be damaged.
- When done, pull the water hoses up and down to check if they are properly connected.

CONNECTING HOSES

Connecting to the Appliance

Ensure that there are no kinks in the hose and that they are not crushed. (Fig. 8).

NOTE After connecting inlet hose to water tap, turn on the water taps to flush out foreign substances (dirt, sand or sawdust) in the water lines. Let water drain into a bucket and check the water temperature.

NOTE After completing connection, if water leaks from the hose, repeat the same steps. Use the most conventional type of faucet for water supply. In case the faucet is square or too big, remove the spacing ring before inserting the faucet into the adaptor.

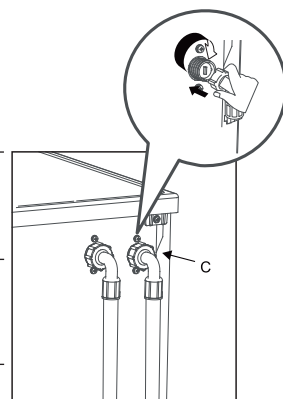

Fig. 8

Connecting to the Drain Hose

Connect the drain hose to a drain duct (with internal diameter of at least 1.6") or place it for drainage in to a sink or a tub, ensuring that there are no kinks or bends. The free end must be at a height of 24" - 40" from the floor. The hose can be held in place using the white plastic clamp on the upper part of the back panel.

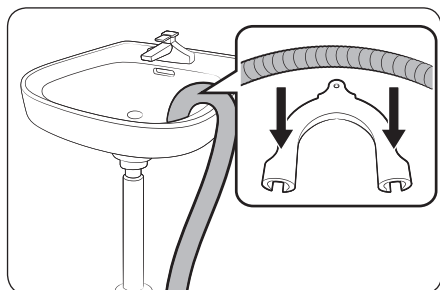

Fig. 9

Height difference between the installation location of the washing machine and the drainage point:
Minimum 24" to Maximum 40"

- Attach water drain hose to U-Connector.
- Hook the U-Connector over the side or stand pipe (Fig. 9)
- When the water is being drained, check that the water flow out of the hose is adequate.

Connecting the Dryer Vent Duct

The Super Combo vents the moist hot air out of the unit and requires a vent hose (standard 4" diameter) to be installed.

To install the vent hose, attach the vent hose (2) onto the vent hose adapter (1) as shown in Fig. 10.

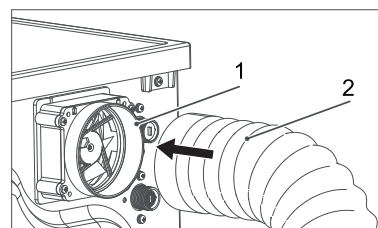

Fig. 10

IMPORTANT: Dryer vent connections and services must be performed by a qualified technician.

MAXIMUM LENGTH OF THE VENT HOSE IS 10 FEET WITH THE 0.5 AMPS ORIGINAL EXHAUST FAN. USING LONGER VENT HOSE MAY DAMAGE INTERNAL COMPONENTS. FOR LONGER VENT HOSE USE 1.5 AMPS EXHAUST FAN, WHICH IS AVAILABLE AS AN ACCESSORY.

DUE TO RISK OF FIRE USE ONLY METALLIC DUCT (RIGID OR FLEXIBLE).

Never use flexible duct inside the dryer.

Do not terminate exhaust in a chimney, range hood, gas vent, floor or attic. The combination of lint and grease could create a fire hazard or damages.

Provide an access for inspection and cleaning the exhaust system at least once a year.

EXHAUST SYSTEM CHECK LIST HOOD OR WALL CAP

Terminate in a manner to prevent back drain or entry of birds or other wildlife.

Termination should present minimal resistance to the exhaust air flow.

Wall caps must be installed at least 12" above ground level or any other obstruction with the opening pointed down.

If roof vents or louvered plenums are used, they must be equivalent to a 4" dampened wall cap in regard to resistance to air flow.

SEPARATION OF TURNS

Separate all turns by at least 3 feet(1 meter) of straight duct, including distance between last turn and dampened wall cap. If two turns must be closer than 3 feet (1 meter) deduct 10 feet (3 meters) from the maximum length.

URNS OTHER THAN 90°

One turn of 45° or less may be ignored.

Two 45° turns should be treated as one 90°.

Each turn over 45° should be treated as one 90°.

For each 90° turn, deduct 33 feet (10 meters) from maximum length.

SEALING OF JOINTS

Tighten all joints to avoid leaks. The male end of the duct must point away from the machine.

Do not assemble the duct work with fasteners that extend into the duct.

Duct joints can be made air and moisture-tight by wrapping the overlapped joints with duct tape.

INSULATION

Duct work which runs through an unheated area or is near an air conditioning duct, should be insulated to reduce condensation and lint build up and be sloped down toward outdoors.

NOTE: Never install screen inside exhaust duct.

WARNINGS: The machine must be exhausted outdoors.

<p>The Exhaust Fan and Exhaust Duct should be cleaned once a year.</p>

OPERATING INSTRUCTIONS

1. Ensure the Combo Washer⊕Dryer is turned off. (Power Indicator light should be off).
2. Separate clothes by type, color and degree of soiling.
3. For small items such as socks and children's clothes, please use a washing net bag.
4. Load clothes of the selected type loosely into the drum.
If you are using Wash Only cycle, you can fill the drum.
If you are using Wash + Dry cycle, please do not load clothes more than 2/3 full.
5. Close the Washer⊕Dryer door. You will hear a click when it is correctly closed.

Add detergent to Dispenser A.

You can add fabric softener in Dispenser B & pre-wash detergent and bleach in Dispenser C (Fig.11).

Detergent Dispenser

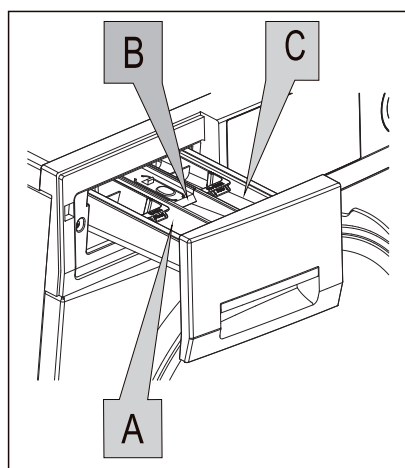

Dispenser A:
Detergent for main wash

Dispenser B:
Fabric softener

Dispenser C:
Detergent for pre-wash and bleach

**The blue cups are only for liquid detergent.
Please do not add powder in these cups.**

Note: Concentrated fabric softener must be diluted with a little water before being poured into the dispenser
(This prevents the overflow siphon from getting blocked)

Fig.11

Your washer/combo is designed to use a high efficiency (HE) detergent, which reduces or eliminates suds and results in more efficient washing.



PROGRAM SELECTION CHART

WASH & DRY, WASH ONLY, DRY ONLY

Wash Programs	Description of Load	Wash Features Water Temp/Spin rpm/Duration	Drying Heat & Approx Time
1 - NORMAL	Mixed cottons	Warm / 1200 / 51 mins	Max heat - 1300W 90 mins
2 - Prewash + Heavy	Thick cottons (towels, jeans)	Cold+Hot / 1400 / 75 mins	Max heat - 1300W 120 mins
3 - Heavy	Mixed cottons (t-shirts, jeans)	Hot / 1400 / 61 mins	Max heat - 1300W 120 mins
4 - ECO	Mixed cottons	Cold / 800 / 31 mins	Max heat - 1300W 80 mins
5 - Quick 20'	Cotton blends, light fabrics	Cold / 1200 / 20 mins	Max heat - 1300W 80 mins
6 - Delicate	Silk, Polyester, etc.	Cold / 800 / 36 mins	Max heat - 750W 80 mins
7 - Wool	Woolens	Cold / 500 / 36 mins	Tumble only NO HEAT
8 - Quiet 60 dB	Mixed cottons	Cold / 800 / 31 mins	Max heat - 1300W 80 mins
9 - Allergen 131°	Bedsheets, etc.	Hot (131°F) / 1200 / 59 mins	Max heat - 1300W 120 mins
10 - Sanitize 165°	Mixed Cottons	Hot (165°F) / 1200 / 69 mins	Max heat - 1300W 120 mins
11 - PET Cycle	Mixed Cottons	Cold / 1200 / 36 mins	Max heat - 1300W 90 mins

DRY CYCLES

Refresh 12 - 12 minutes cycle blowing hot air onto the clothes.

Time Dry 60 - 60 minutes dry cycle.

OTHER CYCLES

Self clean - 40 minutes cycle to clean the inner drum and tub of the machine.

Drain - 2 minutes cycle to drain out the residual water in the tub of the machine.

Winterize - 2 minutes cycle to winterize your appliance.

PET Cycle - For cleaning pet hair - Please see important instructions on page 16.

CONTROL PANEL

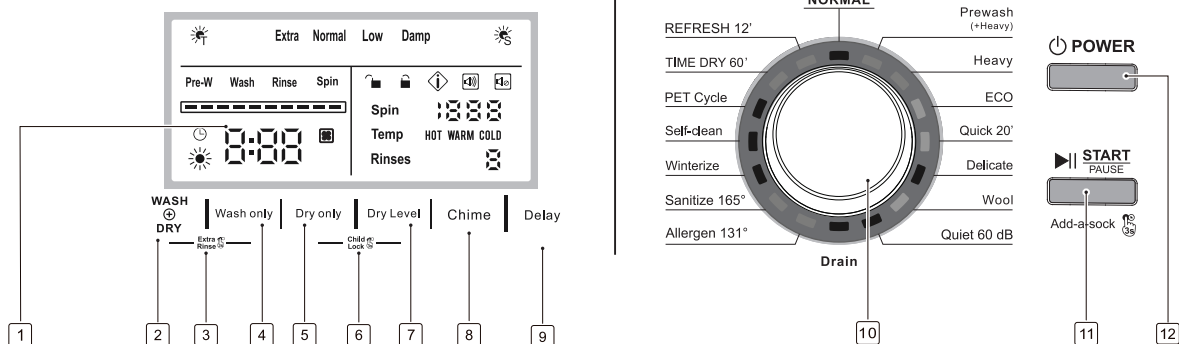

1	Colored LED Display	Displays the information of selected program, such as the water temperature, spin speed, remaining time, rinse times, wash cycles and error messages.
2	Wash + Dry	Press to select wash & dry cycles together.
3	Extra Rinse	To add an extra rinse to the selected cycle, press Wash + Dry and Wash only for 3 seconds before starting.
4	Wash only	Press to select only the wash cycle.
5	Dry only	Press to select only the dry cycle.
6	Child Lock	To prevent children from playing with your machine, press Dry only and Dry Level at the same time for 3 seconds when machine is running.
7	Dry Level	Press to select the dry level for a Sensor Dry cycle. The default is Normal. You can select Extra, Low or Damp Dry.
8	Chime	Press for 3 seconds to turn the chime on or chime off when your machine is running.
9	Delay	To delay the start of the wash cycle, press Delay to select the delay time from 1 to 24 hours, increasing in one-hour increments. To change the delay time, turn the dial to another program, then back to the desired program and reset the delay time.
10	Program Dial Knob	Turn the dial to point to one of the 16 programs depending on the load.
11	Start / Pause button	Press this button to start, or interrupt the selected wash program, or to view the display during a cycle.
12	Power button	Press this button to turn the machine on. Press and hold down this button to turn it off.

DISPLAY PANEL

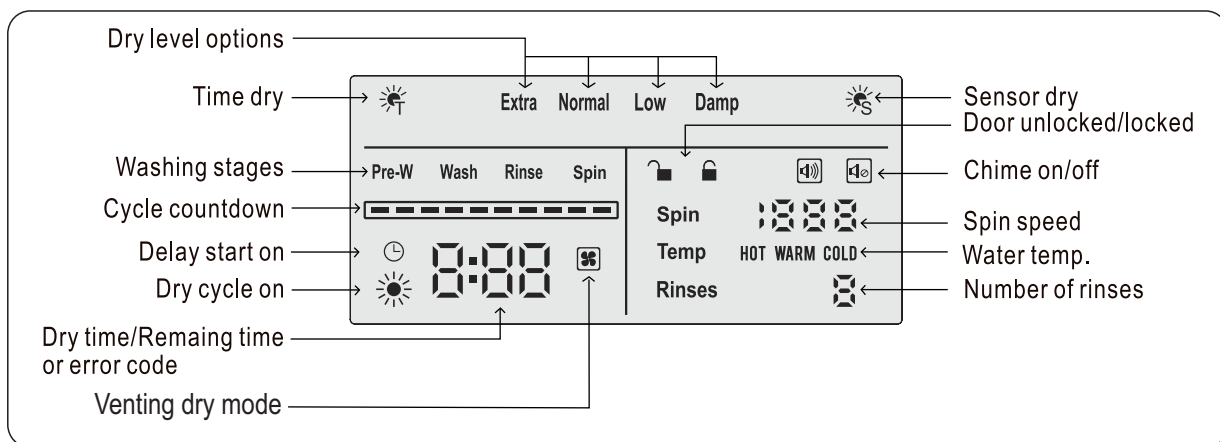

How to run Wash + Dry Cycle

1. Press POWER button
2. Press START

Default cycle is NORMAL - If required you can change to desired washing cycle based on type of clothes by rotating the Program Dial knob.

How to run Wash Only Cycle

1. Press POWER button
2. Press WASH Only
3. Press START

Default cycle is NORMAL - If required you can change to desired washing cycle based on type of clothes by rotating the Program Dial knob.

How to stop the Wash cycle

1. The wash program can be stopped at any time.
2. Press START/PAUSE for 5 seconds.
3. Press POWER button for 3 seconds to turn off the machine.

How to run Dry Only Cycle

1. Press POWER button
2. Press DRY Only
3. Press START

Default cycle is NORMAL and Sensor Dry - You can select Damp, Low or Extra for the desired dry level. You can also select Time Dry for 60 minutes.

4. At the end of the DRY cycle, if the clothes are not completely dry or if the clothes have been in the drum for some time, you can press the Refresh button to dry the clothes and prevent wrinkles.

How to stop the Dry cycle

Press POWER button for 3 seconds to turn off the machine.

SPECIAL FEATURES AND PROGRAMS

Add-a-sock Feature



The wash program can be stopped at any time to add forgotten items to the laundry.

- Press START/PAUSE for 5 seconds.
- Door will open 2 mins after draining water so that it does not overflow.
- Load clothes. Close door.
- Press START The cycle will continue from the point it stopped.

How to turn on the display in energy saving mode?

- Machine display gets turned off automatically during operations to save energy .
- Press any button to turn on display during this energy saving mode .

Door Lock Function

Pressing the START button  will lock the door  → . The wash cycle will start and will continue until the whole program is completed. The door will be locked and cannot be opened until the wash cycle ends. In a few minutes after the cycle ends, the door lock icon will change from locked to unlocked and then you can open the door easily.

Please do not try to force the door open. **Breakage of the door handle is not covered by warranty.**

Pet Cycle

Before loading clothes and sheets into the appliance, remove as much pet hair as possible in order to prevent buildup and clogging of the drain pump. Wipe the surface of clothes and sheets with a lint roller or a damp rubber glove to easily remove pet hair.

After the end of the wash cycle, run a quick wash cycle without clothes. After the cycle ends, wipe down the drum with a damp cloth to collect any pet hair on the drum surface.

Winterizing

How to winterize for cold weather

1. Pour 2 cups of RV type Antifreeze in soap dispenser.
2. Select WINTERIZE cycle on knob and press START. Machine will Rinse & Spin.
3. Open Coin Trap once cycle is finished and drain out remaining water.
4. Shut off water at both faucets and disconnect water inlet hoses from faucets and drain.

Vacations - unplug the appliance

It is recommended that you should unplug the machine from the socket and turn off the water supply. Leave the door ajar to allow air circulation to the draw and the door gasket area. This will prevent unpleasant odors.

MAINTENANCE

Your Washer®Dryer has been designed to operate with easy maintenance.

Follow these simple maintenance procedures to obtain optimum performance:

1. Ensure that your machine was installed according to the correct procedures detailed in this Manual.
2. Do not use solvents either to clean the machine or to wash clothes.
3. Keep the inside of the detergent dispenser clean.

Cleaning the Coin Trap

- Switch off the Washer - Dryer
- Open the service flap. (bottom right corner) (Fig.12)
- Carefully unscrew the coin-trap cover. (Fig.13)
Warning: Some residual water will flow out (approx. 1 cup). Place a pan below the opening.
- Remove foreign objects/fluff from inside and clean the interior. (Fig.14)
- The pump impeller wheel is located behind the water filter, must be able to rotate.
- Remove detergent residue and fluff from the pump cover thread and pump housing.
- Insert the coin-trap cover and screw tight. (Fig.15)
- Insert and close the service flap.

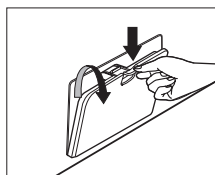

Fig. 12

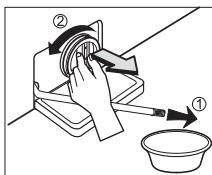

Fig. 13

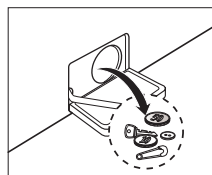

Fig. 14

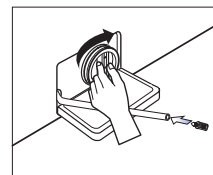

Fig. 15

Cleaning the Detergent Drawers

- Press release lever on the inside of the drawer and pull it out. (Fig.16)
- Remove the cap from the Fabric Softener compartment.
- Wash all of the parts under running water.
- Clean the drawer recess with a small brush. (Fig.17, Fig.18)
- Reinsert the cap (Pushing it firmly into place).
- Push the drawer back into place.
- Run a rinse program without any laundry in the drum.

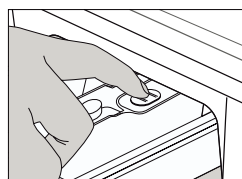

Fig. 16

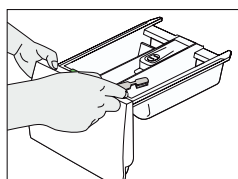

Fig. 17

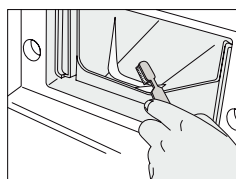

Fig. 18

Cleaning the Exhaust Fan and Duct

Clean the exhaust fan and exhaust duct at least once a year to prevent lint build-up.

Pet Cycle - Maintenance

If the PET Cycle is used, it is important to run a quick wash cycle without clothes following every load. After the cycle ends, wipe down the drum with a damp cloth to collect any pet hair on the drum surface. The lint filter should also be cleaned more frequently.

Cleaning the water inlet filter

- If water is very hard or contains traces of lime deposit, the water inlet filter may become clogged. It is therefore a good idea to clean it from time to time.
- Turn off the water tap. (Fig.19)
- Unscrew the water inlet hose. (Fig. 20)
- Clean the filter using a hard bristle brush under the running water. (Fig. 21)
- **Insert the filter into the valve** and tighten up the inlet hose. (Fig. 22)

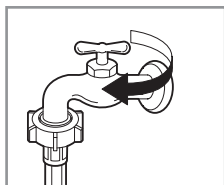

Fig.19

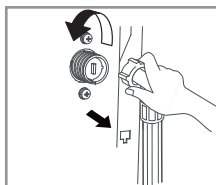

Fig. 20

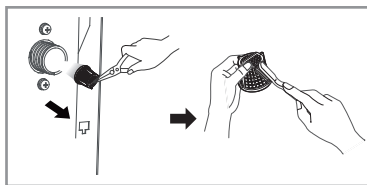

Fig. 21

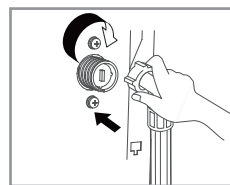

Fig. 22

Cleaning the drum

If you live in a hard water area, limescale may build up continuously in places where it cannot be seen and thus not easily. Over time the build up of scale clogs appliances, and if it is not kept in check these may have to be replaced. Although the washing drum is made of stainless steel, specks of rust can be caused by small metal articles (paper clips, safety pins) which have been left in the drum.

- The washing drum should be cleaned from time to time.
- If you use descaling agents, dyes or bleaches, make sure they are suitable for washing machine use.
- Descaler may contain chemicals that may damage part of your washing machine.
- Remove any spots with a stainless steel cleaning agent.
- Never use steel wool.

Cleaning the machine

1.Exterior

Proper care of your washer can extend its life.

- The outside of the machine can be cleaned with warm water and a neutral non abrasive household detergent.
- Immediately wipe off any spills. Wipe with damp cloth.
- Try not to hit surface with sharp objects.
- Do not use methyated spirits, diluents or similar products.

2.Interior

- Dry around the washer door opening, flexible gasket and door glass.
- Run washer through a complete cycle using hot water.
- Repeat process if necessary.



To remove hard water deposits, use only cleaners labelled washer safe.

TROUBLESHOOTING

In most cases, when your Washer⊕Dryer fails to work, the problems arising can be easily solved without having to call for a technician. Before calling for assistance, always check these points.

Does not start

- Plug correctly inserted into the socket?
- Electricity in the house?
- Door closed properly?
- Start button pressed?
- Power button pressed?
- Washer knob in the correct position for the cycle to start?
- Do any other devices work on that particular socket?

Does not fill with water

- Hose correctly connected to the faucet?
- Water supply turned on?
- Sufficient water pressure?
- Faucet filter clean?
- Inlet hose kinked?

Continuously fills and drains water

- Is the drain hose positioned too low?
- Check that the inlet hose is not connected at a height more than 4" above the floor.

Does not drain or spin

- Does selected program incorporate water draining?
- Drain pump clogged?
- Drain hose kinked?
- Coin trap clean?

There are too many suds in the drum

- Is Front loading detergent being used? It is recommended to use Front Load detergent
- Is the correct amount of detergent being used?

Vibrates during the spin cycle

- Have all shipping bolts been removed during installation?
- Machine levelled correctly?
- Is there enough space between the machine and adjacent units?
- Is the machine loaded evenly?
- Is the machine installed on carpet or on a wooden floor?

Leaks

- Is the metal ring of the inlet hose properly attached?
- Is the detergent dispenser obstructed?
- Is the drain hose inserted correctly into the drain?

Not drying

- Is the dryer button correctly pressed for the drying cycle?
- Is drying cycle selected (Time Dry/Sensor Dry)?

Not drying efficiently

- Is the end of the drain hose under water?
- Is the drain pump obstructed?
- Is the drum overloaded?
- Is the cold water faucet open?
- Is fabric softener being used?

Condensation at soap dispenser

- Slight condensation can occur at soap dispenser and will evaporate. This is normal.

ERROR CODES

Code	Description	Component
E1	Door open	Door Switch
E2	Drain failure	Drain Pump
E3	Water inlet failure	Inlet Valves
E4	Water overflow	Pressure Switch
E5	Motor failure	Motor +Electronic Module
E7	Washing heater failure	Washing heater
E8	Dryer Malfunction	Temp. sensor (@rear-bottom of tub)
E9	Dryer Malfunction	Temp. sensor (@front of heater housing)
E10	Water level failure	Water level sensor
E11	Dryer Malfunction	Temp. sensor (near the blow fan motor)
E12	Dryer Malfunction	Fan Motor
E13	Dryer Malfunction	Drying heater
E16	Communication between display & electronic module	Communication Cable

To order parts : www.ApplianceDesk.com/Parts