

DV45DG6000HW

SAMSUNG

Large 7.5 cu. ft. Capacity Ventless Hybrid Heat Pump Dryer with Sensor Dry



Available Color



Features

- Ventless Hybrid Heat Pump
- Wi-Fi with SmartThings¹
- ENERGY STAR[®] Most Efficient²
- Self Dry
- Sensor Dry
- Large 7.5 cu. ft. Capacity
- Lint Filter Indicator
- Stainless Steel Drum
- 360 Air Flow
- 3 Layered Filter System
- Internal Drum Light
- Reversible Dryer Door
- Matching Washer
- Matching Accessories
- 20 Total Drying Cycles
- 6 Drying Options
- 4 Dry Levels

Convenience

- Child Lock
- Lint Filter Indicator

Ratings



ENERGY STAR[®] Rated:
263 kWh/yr

Electrical Requirements

240 V / 60 Hz
14 Amps

Specifications

20 Total Drying Cycles:

eco Normal, Normal, Heavy Duty, Towels, Perm Press, Activewear, Bedding, Delicates, Wool, Sanitize, Shirts, Denim, Time Dry, Air Fluff, Quick Dry, Air Bedding Care, Down Jacket Care, Outdoor Care, Self Dry, Downloaded

6 Drying Options:

Damp Alert, Wrinkle Prevent, Smart Control, Sound Off, Drum Light, Child Lock

4 Dry Levels:

More Dry, Normal Dry, Less Dry, Damp Dry

Warranty

One (1) Year Parts and Labor

Product Dimensions & Weight (WxHxD)

Dimensions: 27" x 38³/₄" x 33¹/₄"

Weight: 154.3 lbs

Shipping Dimensions & Weight (WxHxD)

Dimensions: 29³/₈" x 43¹⁵/₁₆" x 34⁷/₈"

Weight: 163.1 lbs

Heat Pump Dryer	Model #	UPC Code
White	DV45DG6000HW	887276886145

Matching Electric Dryers

White	DVE45T6000W	887276412634
White (Long Vent)	DVE45T6020W	887276438153

Matching Gas Dryers

White	DVG45T6000W	887276412641
White (Long Vent)	DVG45T6020W	887276438160

Matching Washer

White	WF45T6000AW	887276394794
-------	-------------	--------------

Optional Accessories	Model #	UPC Code
Stacking Kit	SKK-8HK	887276888132
White Pedestal	WE402NW/A3	887276310152
Riser	WE272NW	887276197647

¹ Available on Android and iOS devices. A Wi-Fi connection and a Samsung account are required. Only monitoring enabled on Gas dryers for safety reasons.

² Visit www.energystar.gov for more information on ENERGY STAR[®] guidelines.

DV45DG6000HW

SAMSUNG

Large 7.5 cu. ft. Capacity Ventless Hybrid Heat Pump Dryer
with Sensor Dry

Dimensions

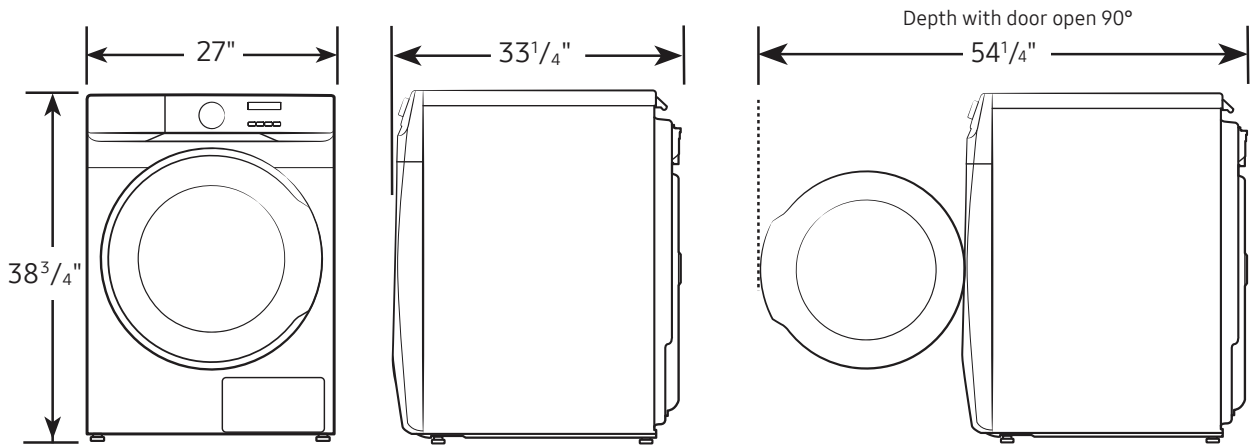

Installation Specifications – Side-by-Side or Stand-Alone

If the washer and dryer are installed together or the dryer alone, the closet front must have two unobstructed air openings for a combined minimum total area of 72-inch². Your washer alone does not require a specific air opening.

Alcove or closet installation
Minimum clearances for
closet and alcove installations:

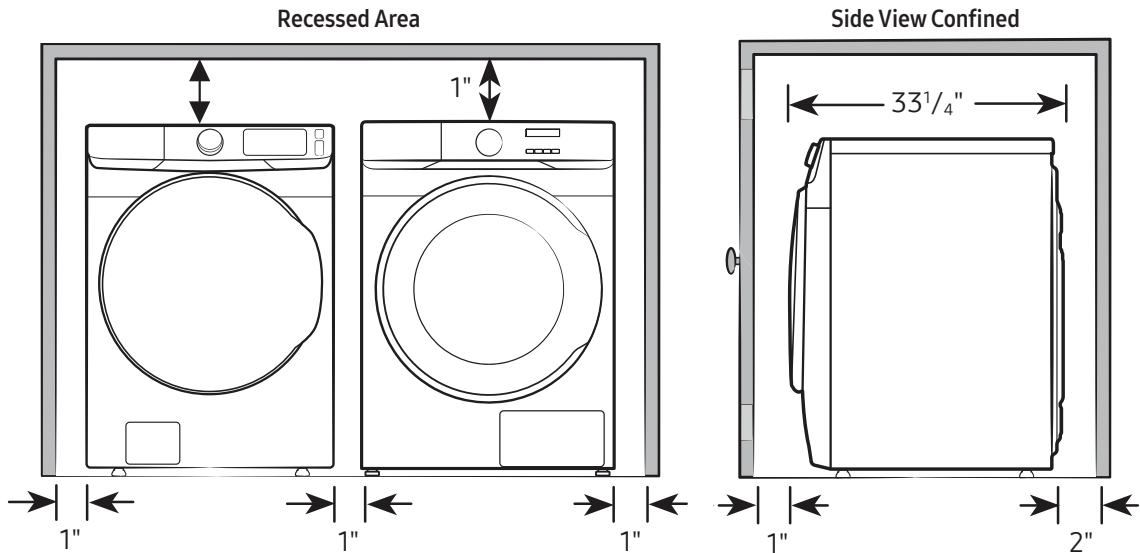

Actual color may vary. Design, specifications, and color availability are subject to change without notice. Non-metric weights and measurements are approximate.

©2024 Samsung Electronics America, Inc., 85 Challenger Road, Ridgefield Park, NJ 07660. Tel: 800-SAMSUNG. samsung.com. Samsung is a registered trademark of Samsung Electronics Co., Ltd.

DV45DG6000HW

SAMSUNG

Large 7.5 cu. ft. Capacity Ventless Hybrid Heat Pump Dryer
with Sensor Dry

Installation Specifications – Stacked Pair

Clearances indicated are for stacked pairs. The closet front must have two unobstructed air openings for a combined minimum total area of 72-inch².

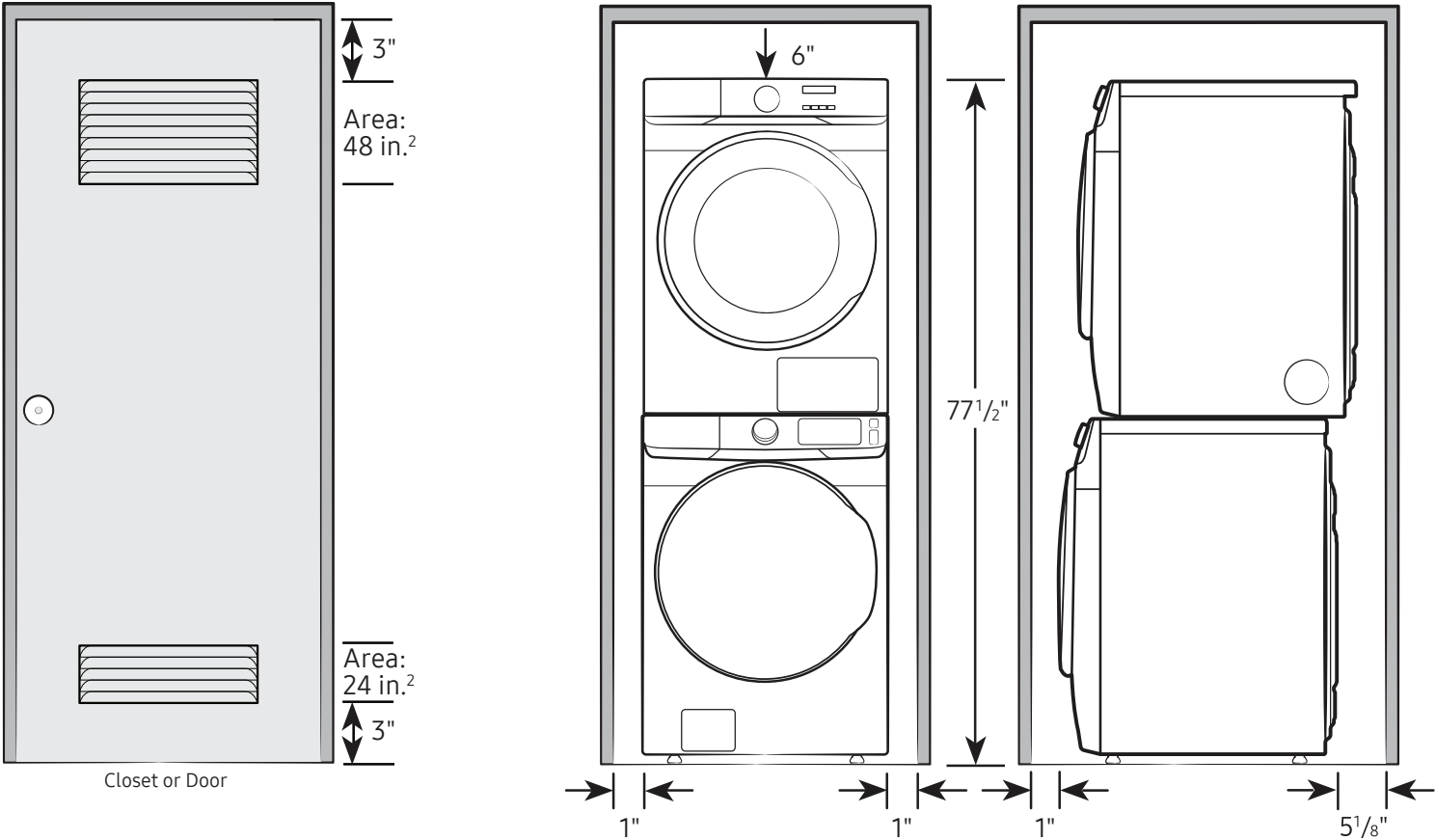

Connection Dimensions

Back and side views of stacked pair

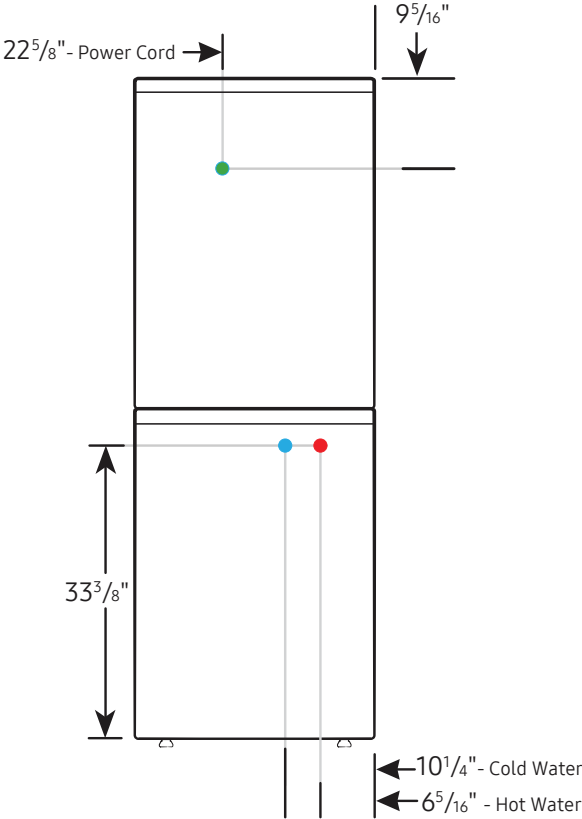

- LEGEND:
- Power Cord
 - Cold Water Connection
 - Hot Water Connection

Actual color may vary. Design, specifications, and color availability are subject to change without notice. Non-metric weights and measurements are approximate.

©2024 Samsung Electronics America, Inc., 85 Challenger Road, Ridgefield Park, NJ 07660. Tel: 800-SAMSUNG. samsung.com. Samsung is a registered trademark of Samsung Electronics Co., Ltd.